

PO Box 188
340-3545 32nd Ave NE
CALGARY, ALBERTA, CANADA
T1Y 6M0

NOTICE
The purchaser agrees when purchasing this plan ("Plan") that the purchaser has accepted the right to build or construct the object or project set out in the Plan (the Project) for his/her/its personal use and not for any commercial use. The reproduction of the Plan in whole or in part by any means whatsoever is strictly prohibited. The Handymen Project is not to be used to mislead or misrepresent the use of this plan, the Project or for any other purpose. The Project or for any other purpose resulting therefrom.

NOTE: Read all directions before beginning

Carpenter's glue should be used to reinforce all joints. Set oil nails and countersink screws - use wood filler as necessary to spot nails and screws before finishing wood. Dimensions shown in brackets denote millimetres. Wipe off excess glue with a wet cloth before it has time to set.

Directions:

Procedure 1) - See Figure 1

Begin your project by laying out all materials as illustrated in Figure 1. Mark (pencil) all dimensions on the material. For straight lengths, use a square and a spirit level. (Along with a spirit level, compass or other gauge if required) draw out all the parts exactly as shown using the dimensions and shapes illustrated in Figure 2 (Cutting Diagram). Be sure to include the part number designation for each piece as well. The dots in pieces B,C,P & Q may be made using a dotto block or using multiple cross cuts on your table saw, your cut should be made perpendicular to the grain of the wood. You can use a coping saw or merely cut straight with a table or hand saw, and sanded to final shape.

The angles on pieces D & H are important, as any change in these will affect the fit of other pieces as well as the angle of the seat and back in pieces G, E, & F. Therefore, the angle of the seat and back in pieces G, E, & F should be made from the angle of a 24" string tied to it. Ensure the focal point of the arc is located as precisely as possible using the dimensions as illustrated in the Cutting Diagram.

Due to the complexity and number of various pieces, and as this is a patterned and finished finishing with stain or oil prior to assembling the project.

In the lower left corner we have illustrated the cutting diagram for the various table top pieces (Pieces S). Although these parts are shown with the exact lengths as derived from the computer, we suggest you make the exact in laying out dimensions. We suggest that you build the table as outlined in Step #9, and then cut the pieces S to a rough length, lay them in place on the table top, using a 1/2" spacer between each piece, and mark the exact size and shape with a pencil from below the table. This procedure will allow perfect fit of the table top pieces.

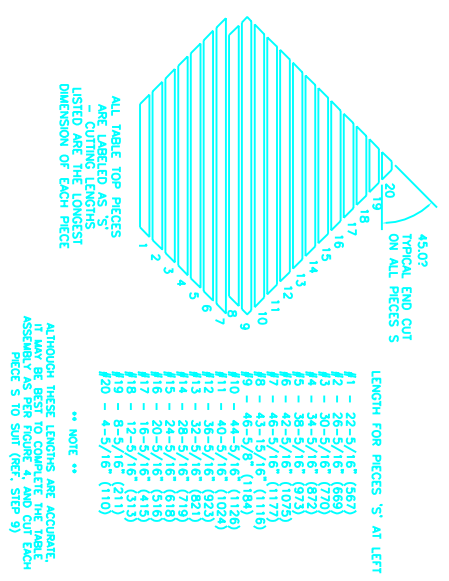

LENGTH FOR PIECES 'S' AT LEFT

#1	22-5/16" (567)
#2	20-5/16" (519)
#3	18-5/16" (471)
#4	16-5/16" (423)
#5	14-5/16" (375)
#6	12-5/16" (327)
#7	10-5/16" (279)
#8	8-5/16" (231)
#9	46-5/8" (1184)
#10	44-5/16" (1126)
#11	40-5/16" (1024)
#12	38-5/16" (972)
#13	36-5/16" (920)
#14	34-5/16" (872)
#15	32-5/16" (820)
#16	30-5/16" (772)
#17	28-5/16" (720)
#18	26-5/16" (672)
#19	24-5/16" (620)
#20	4-5/16" (110)

ALL TABLE TOP PIECES ARE LABELED AS 'S' - CUTTING LENGTHS LISTED ARE THE LONGEST DIMENSION OF EACH PIECE

ALTHOUGH THESE LENGTHS ARE APPROPRIATE, IT MUST BE TEST TO COMPLETE THE TABLE ASSEMBLY AS PER FIGURE 4 AND CUT EACH PIECE S TO SIZE (REF. STEP 9)

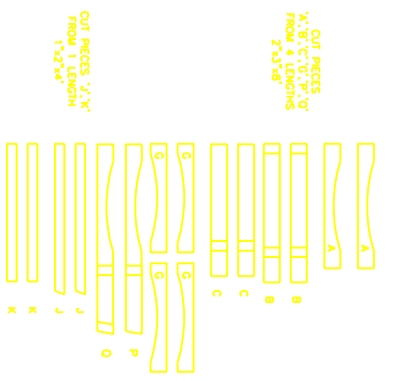

MATERIALS LAYOUT
FIGURE 1

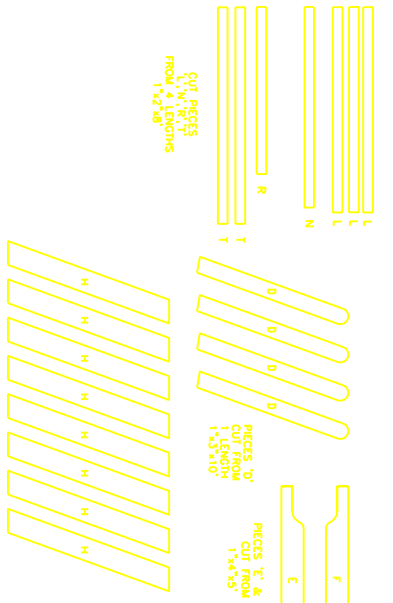

8 LEGS CUT FROM 3 LENGTHS 2.3x4x8

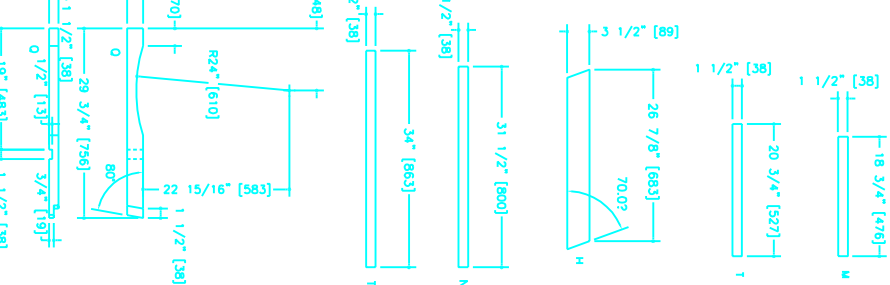
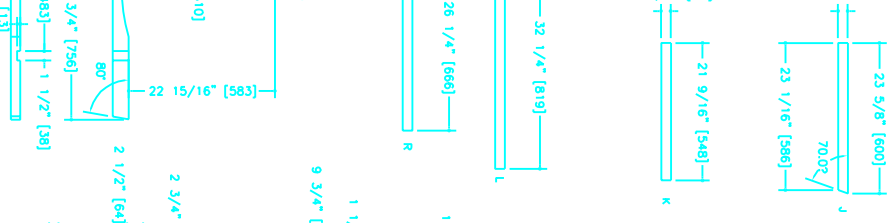
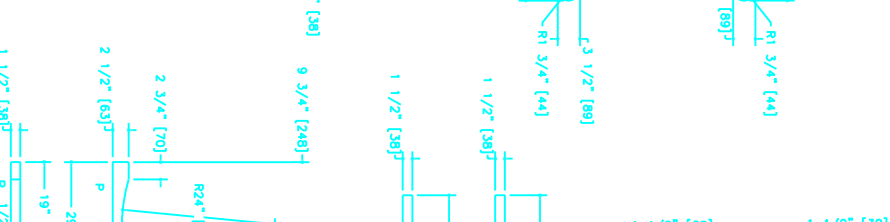
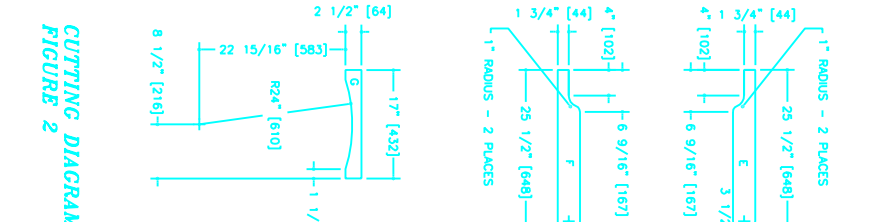
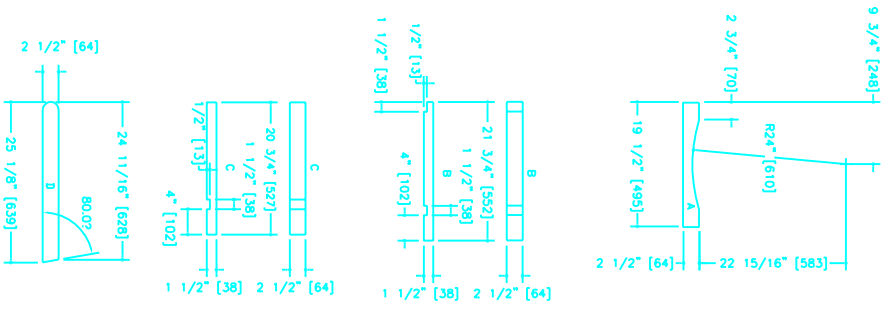
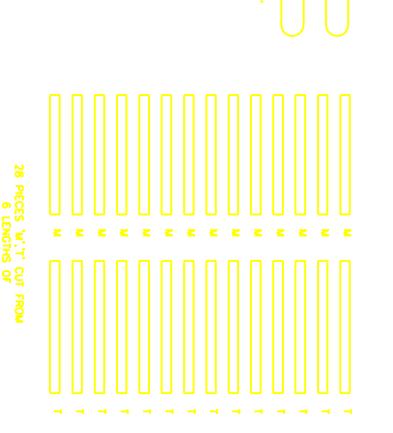

CUTTING DIAGRAM
FIGURE 2

MATERIALS LIST

- Three 2"x3"x8" (Cedar or Redwood)
- One 2"x2"x4" (Cedar or Redwood)
- Eleven 1"x2"x8" (Cedar or Redwood)
- Three 2"x4"x8" (Cedar or Redwood)
- One 1"x4"x5" (Cedar or Redwood)
- One 1"x3"x10" (Cedar or Redwood)

MATERIALS LIST

- Approx. 100 1"-1/2" #10 Flathead Screws
- Approx. 50 2-1/2" #10 Flathead Screws
- Carpenter's Glue
- Sandpaper
- Oil or Stain

TOOLS

- Table Saw and Jigsaw
- Pencil, Tape, and Square
- Power Drill and Protractor
- 5/64" 3/32" 7/64" Drill Bits
- Hammer and Screwdrivers
- Paint Brush and Putty Knife
- Power Sander (optional)

Blueprints for the Handyman Presents
TEETE-A-TEETE (Corner) - Project #218

© 1990 Blueprints for the Handyman